

DOME FLANGE

BLIND RIVETS

SECTION 2

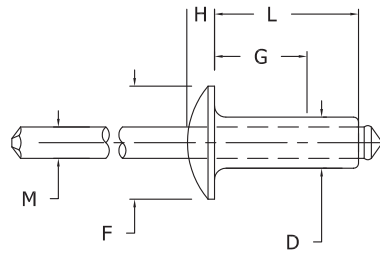

AFTER INSTALLATION



STEEL RIVET/STEEL MANDREL

Part Number	Hole Size And Drill Number	Mandrel Ø (M)	Flange Ø (F)	Max. Head Height (H)	Max. Barrel Length (L)	Rivet Size (D)	Grip Range (G)	Typical Strength	
								Shear	Tensile
SSA 32	.096-.100	.057	.188	.032	.250	3/32	.020 - .125	150 lbs	205 lbs
34	#41				.375		.126 - .250		
SSA 41	.129-.133 #30	.076	.250	.045	.212	1/8	.020 - .063	295 lbs	425 lbs
42					.275		.063 - .125		
43					.337		.126 - .187		
44					.400		.188 - .250		
45					.462		.251 - .312		
46					.525		.313 - .375		
48					.650		.376 - .500		
410					.775		.501 - .625		
SSA 52	.160-.164 #20	.095	.312	.055	.300	5/32	.063 - .125	410 lbs	570 lbs
53					.362		.126 - .187		
54					.425		.188 - .250		
56					.550		.251 - .375		
58					.675		.376 - .500		
510					.800		.501 - .625		
SSA 62	.192-.196 #11	.114	.375	.060	.325	3/16	.063 - .125	590 lbs	815 lbs
63					.387		.126 - .187		
64					.450		.188 - .250		
66					.575		.251 - .375		
68					.700		.376 - .500		
610					.825		.501 - .625		
612					.950		.626 - .750		
614					1.075		.751 - .875		
616	1.200	.876 - 1.000							
SSA 84	.257-.261 F	.151	.500	.080	.500	1/4	.063 - .250	1245 lbs	1505 lbs
86					.625		.251 - .375		
88					.750		.376 - .500		
810					.875		.501 - .625		
812					1.000		.626 - .750		
814					1.125		.751 - .875		
816	1.250	.876 - 1.000							

Product specification are in effect at the time of publishing

CBRC 1.800.258.2579

LARGE FLANGE

BLIND RIVETS

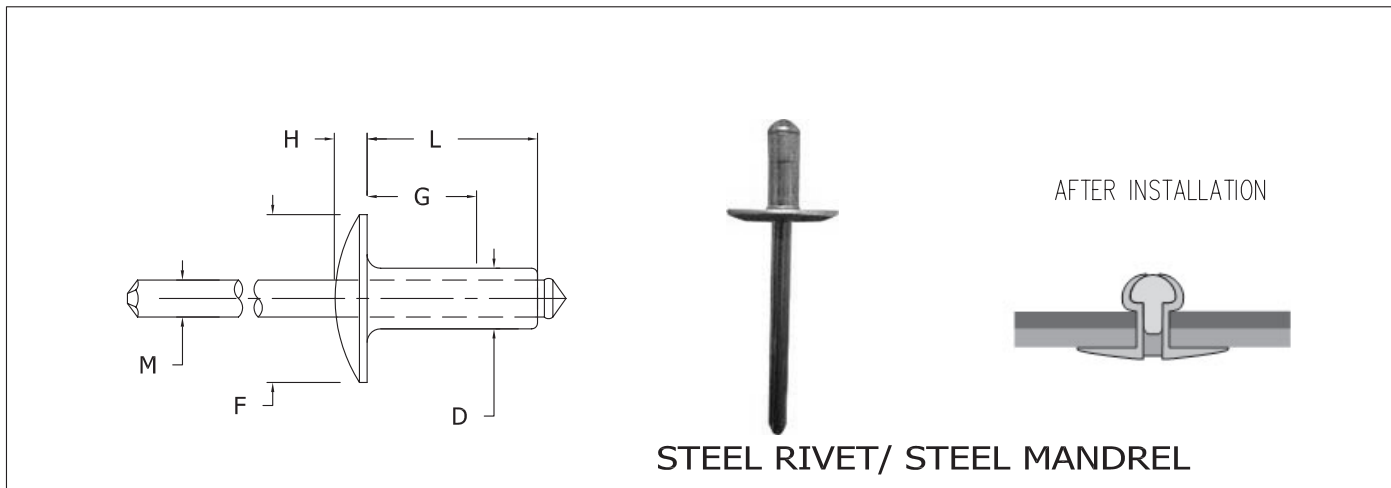

STEEL RIVET/ STEEL MANDREL

Part Number	Hole Size And Drill Number	Mandrel Ø (M)	Flange Ø (F)	Max. Head Height (H)	Max. Barrel Length (L)	Rivet Size (D)	Grip Range (G)	Typical Strength	
								Shear	Tensile
SSB 42	.129-.133 #30	.076	.375	.065	.275	1/8	.020 - .125	295 lbs	425 lbs
43					.337		.126 - .250		
44					.400		.188 - .250		
46					.525		.251 - .375		
SSB 54	.160-.164 #20	.095	.468	.075	.425	5/32	.063 - .250	410 lbs	570 lbs
56					.550		.251 - .375		
SSB 64	.192-.196 #11	.114	.625	.092	.450	3/16	.020 - .250	590 lbs	815 lbs
66					.575		.251 - .375		
68					.700		.376 - .500		
610					.825		.501 - .625		
612					.950		.626 - .750		
616					1.200		.876 - 1.000		

Product specification are in effect at the time of publishing

COUNTERSUNK FLANGE

BLIND RIVETS

SECTION 2

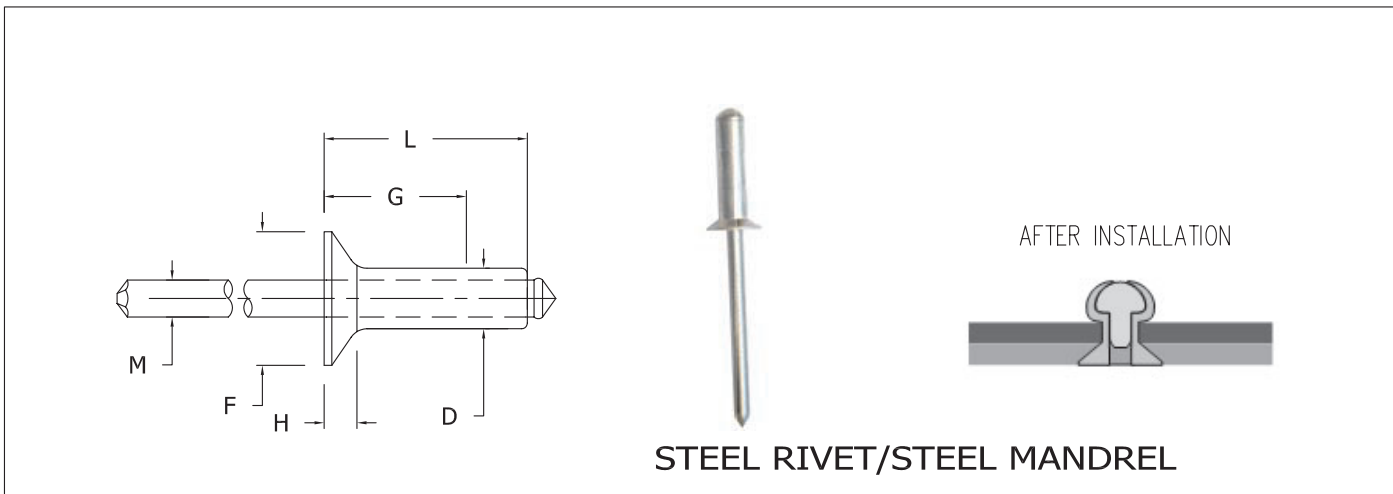

Part Number	Hole Size And Drill Number	Mandrel Ø (M)	Flange Ø (F)	Max. Head Height (H)	Max. Barrel Length (L)	Rivet Size (D)	Grip Range (G)	Typical Strength	
								Shear	Tensile
SSC 42	.129-.133 #30	.076	.220	.031	.275	1/8	.063 - .125	295 lbs	425 lbs
43					.337		.126 - .187		
44					.400		.188 - .250		
46					.525		.251 - .375		
SSC 52	.160-.164 #20	.095	.281	.040	.300	5/32	.063 - .187	410 lbs	570 lbs
54					.425		.188 - .250		
56					.550		.251 - .375		
58					.675		.376 - .500		
SSC 63	.192-.196 #11	.114	.348	.050	.387	3/16	.063 - .187	590 lbs	815 lbs
64					.450		.188 - .250		
66					.575		.251 - .375		
68					.700		.376 - .500		
610					.825		.501 - .625		
612					.950		.626 - .750		
614					1.075		.751 - .875		

Product specification are in effect at the time of publishing